

# Characterisation, cultural heritage & the future development of landscapes



Chris Dalglish  
[chris.dalglish@glasgow.ac.uk](mailto:chris.dalglish@glasgow.ac.uk)

Kenny Brophy, Helen Green



Alan Leslie, Gavin MacGregor



Aphrodite Sorotou



collaboration  
& support

THE CARNEGIE TRUST  
FOR THE UNIVERSITIES OF SCOTLAND



the relationship between characterisation, governance & development . . .

‘landscape’s meaning has . . . [changed] from being a polity constituted by common *thing* meetings treating substantive *things that matter*, to becoming a spatial assemblage of physical *things as matter*.’

Olwig, K 2013 in *Geografiska Annaler: Series B, Human Geography* 95.3

Principles for  
characterisation





Principles for  
characterisation

Law Ting Holm – open air assembly site, Shetland

[www.facebook.com/pages/The-Assembly-Project/125731930802039](https://www.facebook.com/pages/The-Assembly-Project/125731930802039)

‘crap places kill people . . . great places . . . . bring life . . . . by bringing purpose and meaning to people – not just in the finished product, but in the process . . . . by getting people to build it themselves . . . . The arduous common task creates community – which is common life . . . .’

Rowe, C. 10 October 2012; [http://www.theglasshouse.org.uk/blog-entry/\\_/if-crap-places-kill-people-what-can-great-places-do/68/](http://www.theglasshouse.org.uk/blog-entry/_/if-crap-places-kill-people-what-can-great-places-do/68/)

Principles for  
characterisation





Case study

Govan (Glasgow)

[www.rcahms.gov.uk](http://www.rcahms.gov.uk)





## Case study

Govan Old Parish Church

<http://thegovanstones.org.uk/>  
<http://weavingtruthwithtrust.wordpress.com>



PALACE

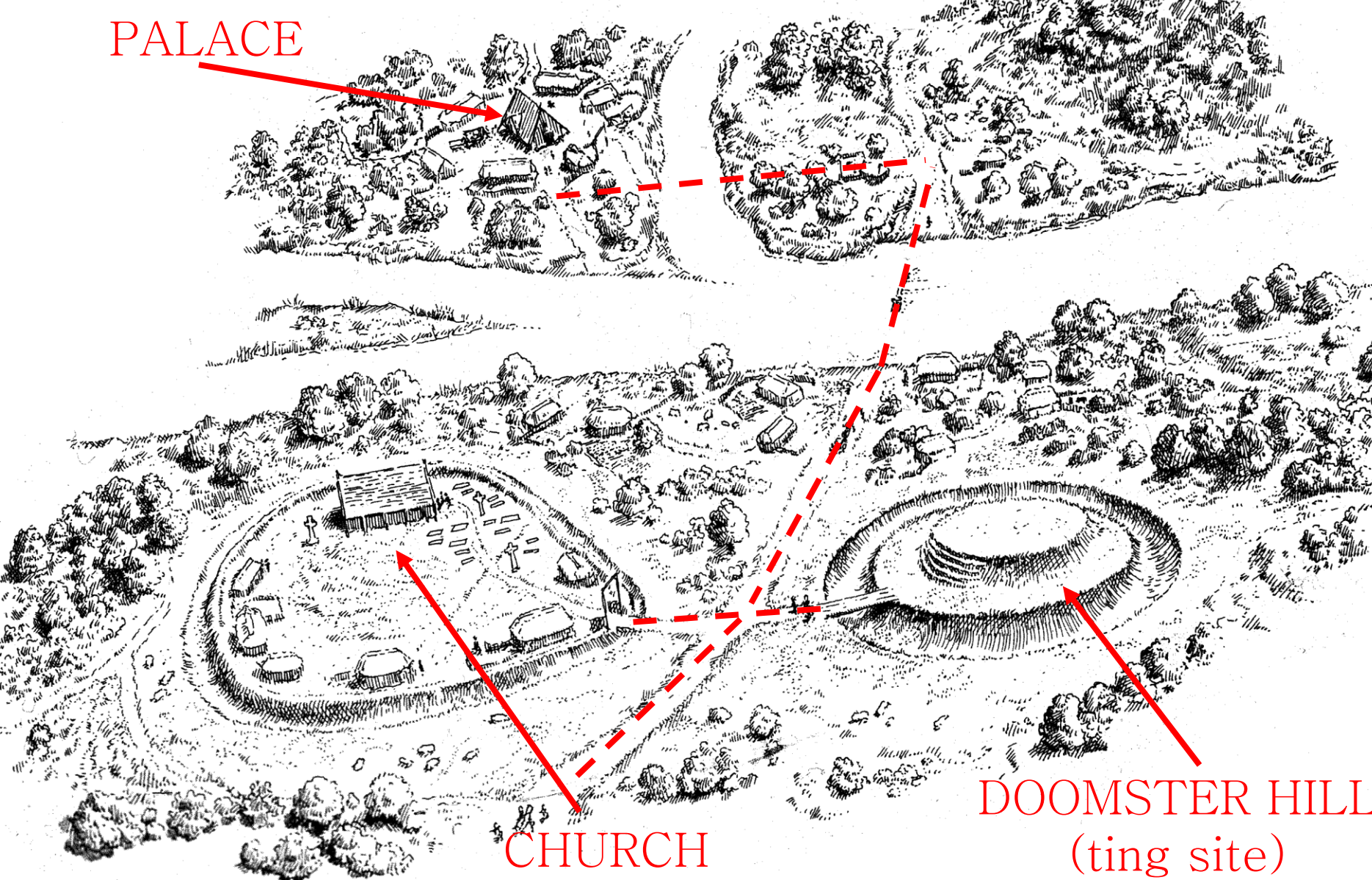

Case study

Govan c. A.D. 1000





Case study

Govan c. A.D. 2000



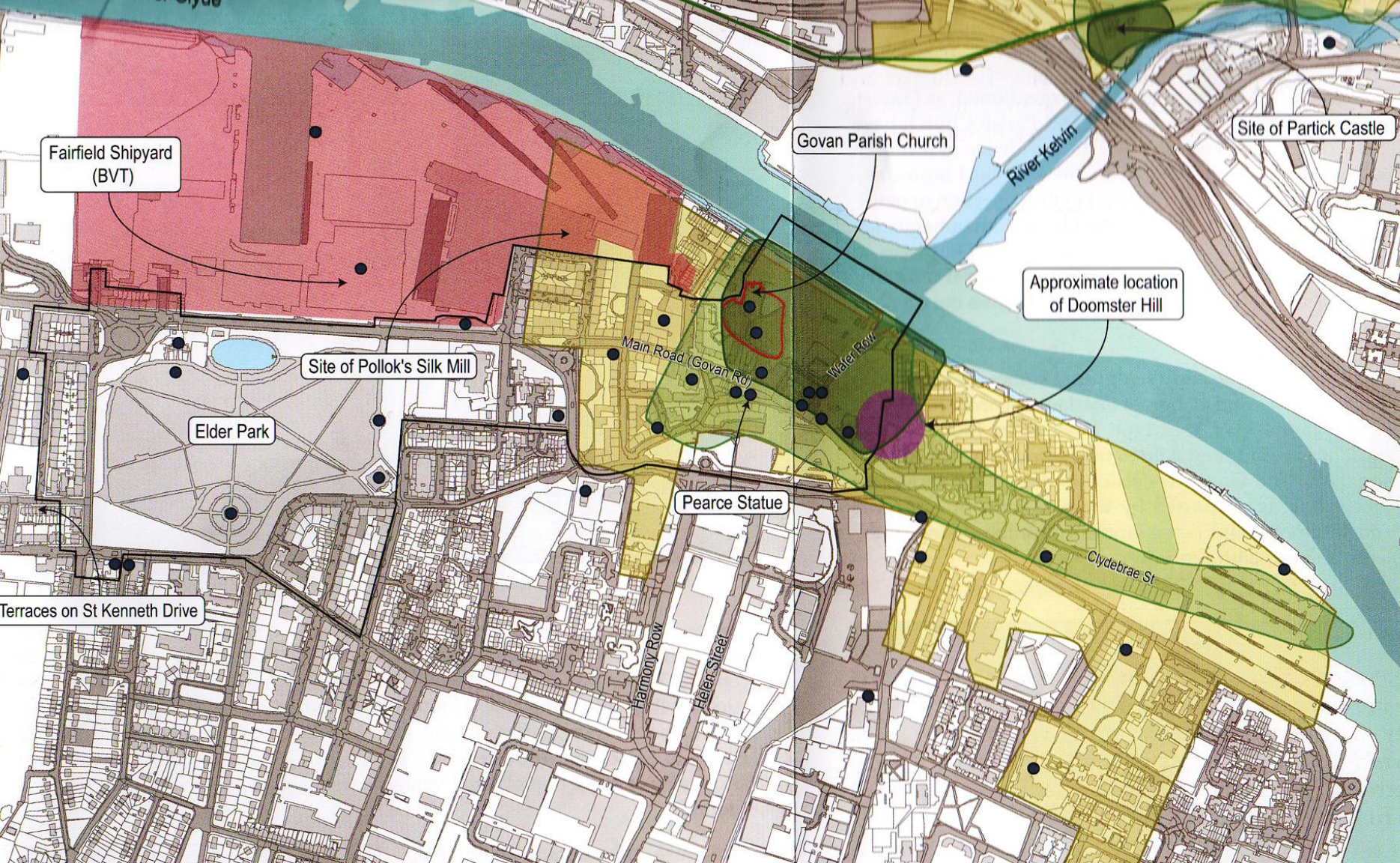

Case study

## Govan *Burgh* Survey

Dalglisch & Driscoll 2009 *Historic Govan*. Historic Scotland.



Visions and plans:

- *Central Govan Action Plan* (McInally Associates 2005)
- *A Conservation Plan for Govan* (David Robertson 2006) & other proposals
- *Water Row Visioning* (Edo Architecture 2012) & related projects and activities

Case study

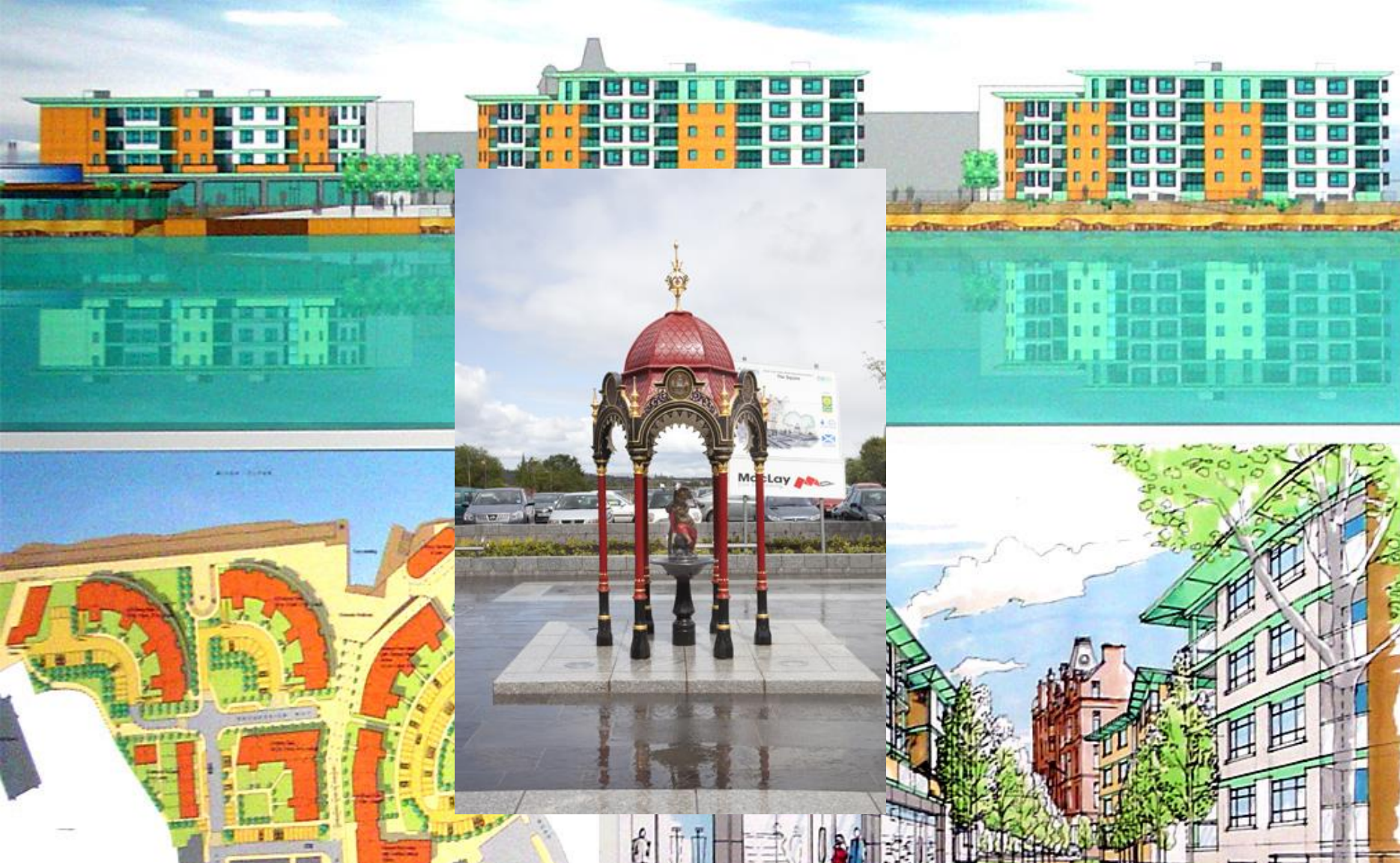

## Case study

The historic landscape as material asset

*Central Govan Action Plan*, McNally Associates 2005



# CENTRAL GOVAN ACTION PLAN

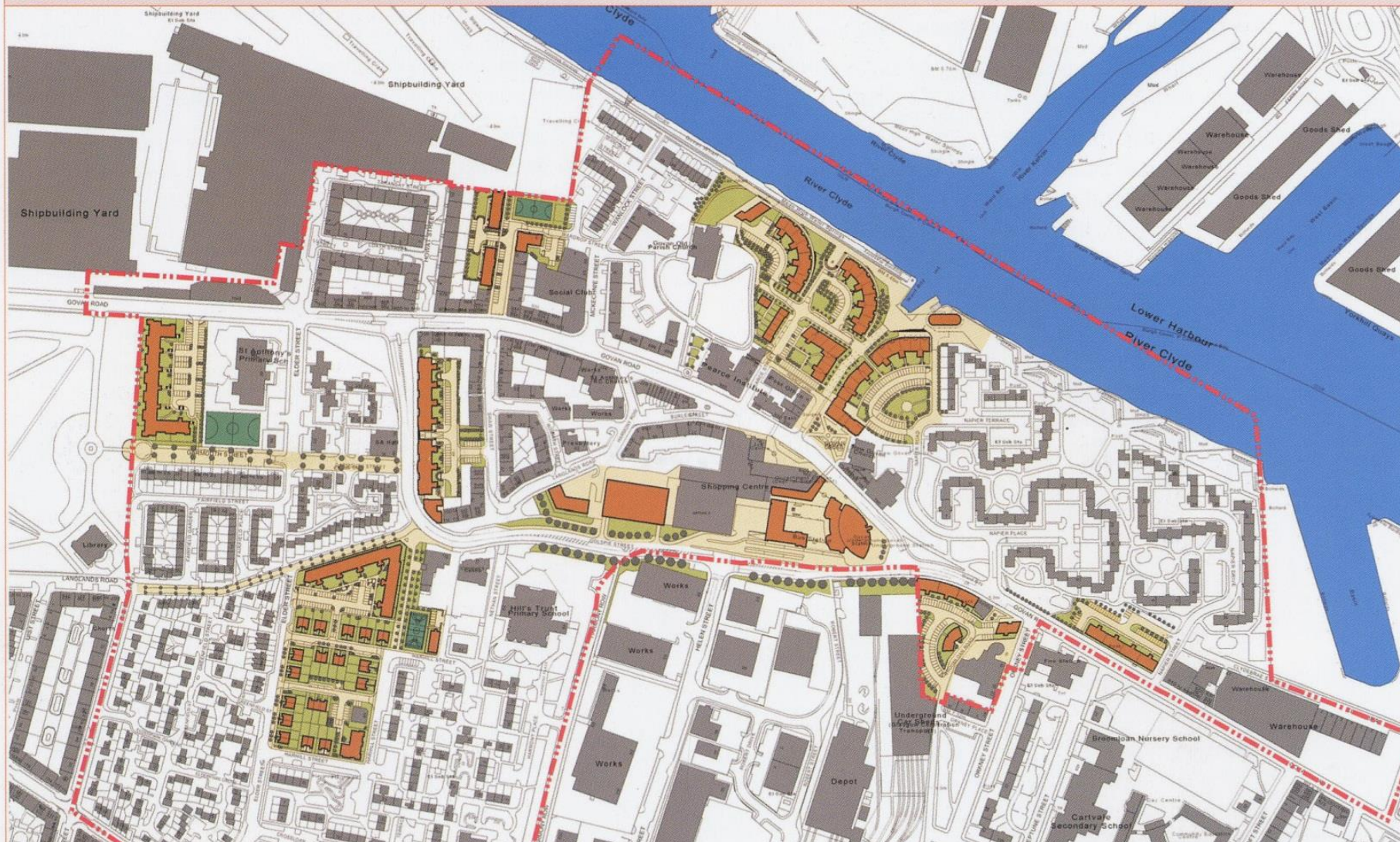

Case study

The historic landscape: connection & disconnection

*Central Govan Action Plan, McNally Associates 2005*



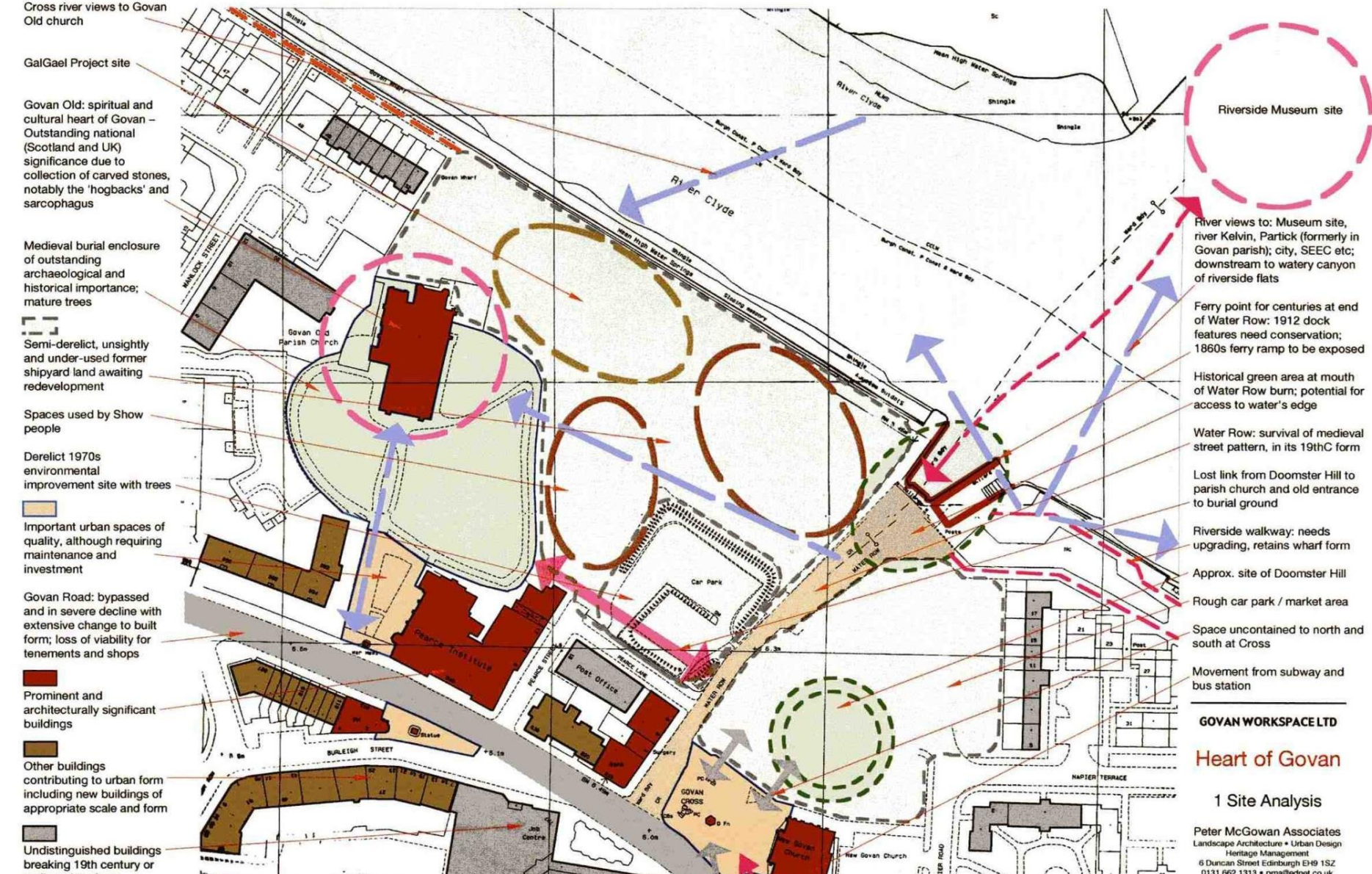

## Case study

The historic landscape: connection & disconnection

*Govan Workspace Ltd. 2006*



# MISSING

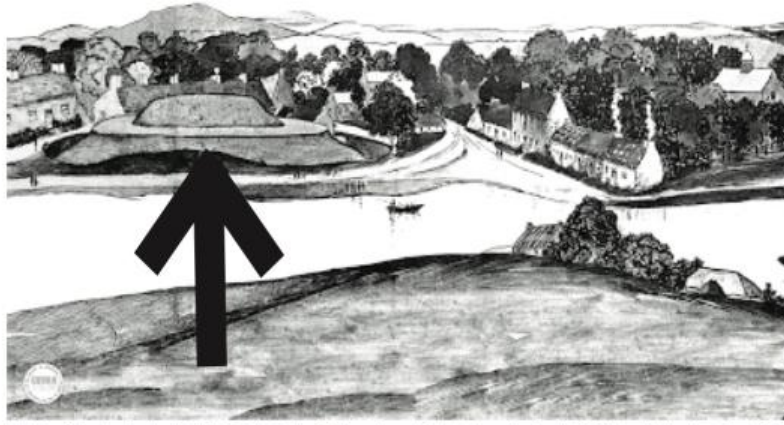

**HAVE YOU SEEN THIS HILL?**

Roughly 45m in Diameter, 5m high.

Last seen around Water Row, circa 18th Century.

Answers To; Doomster Hill, Little Hill

If You Have Any Information, Please Contact  
[missinginvestigationteam@gmail.com](mailto:missinginvestigationteam@gmail.com)

[facebook.com/SomeThingsMissingGovan](https://facebook.com/SomeThingsMissingGovan) @STIMGOVAN

<http://somethingismissinggovan.wordpress.com/>



<http://weavingtruthwithtrust.wordpress.com/>



# diving for pearls

**Exhibition Launch** (traditional boat building materials, public art piece, archive images and oral histories)  
**Documentary Short Film Screenings**  
**Theatre & Dance / Song & Music**  
**Storytelling Open Mic**  
**Stalls & Food**

**community celebration FREE EVENT**

**Saturday 15th June** - Pearce Institute, Café 13 & Govan Town Square - 1pm til evening

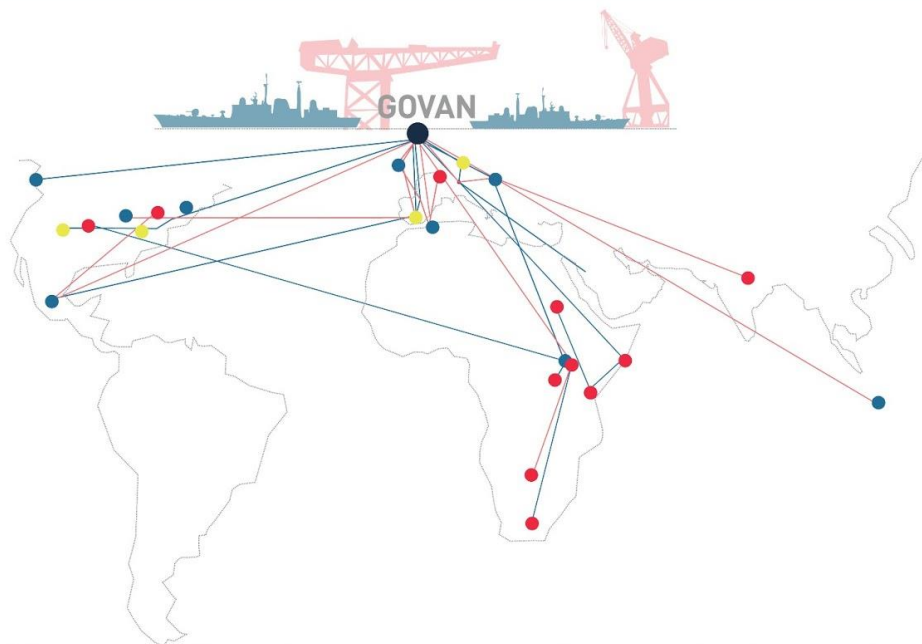

'Phew, what to say! Your multifaceted project looks to me like about the best thing to be doing right now – grassroots politics being it seems the only politics that can rescue serious issues from our obtusely weird professional political elites. Good fun as well as seriously helpful to the vulnerable!'

- **Robert Wyatt** singer of the original version of **Shipbuilding**

[www.gcin.org.uk/divingforpearls](http://www.gcin.org.uk/divingforpearls)  
0141 445 3718

Govan & Craigton  
Integration Network



<http://www.aboutuswithoutus.com/>

<http://www.gcin.org.uk/diving-for-pearls.html>



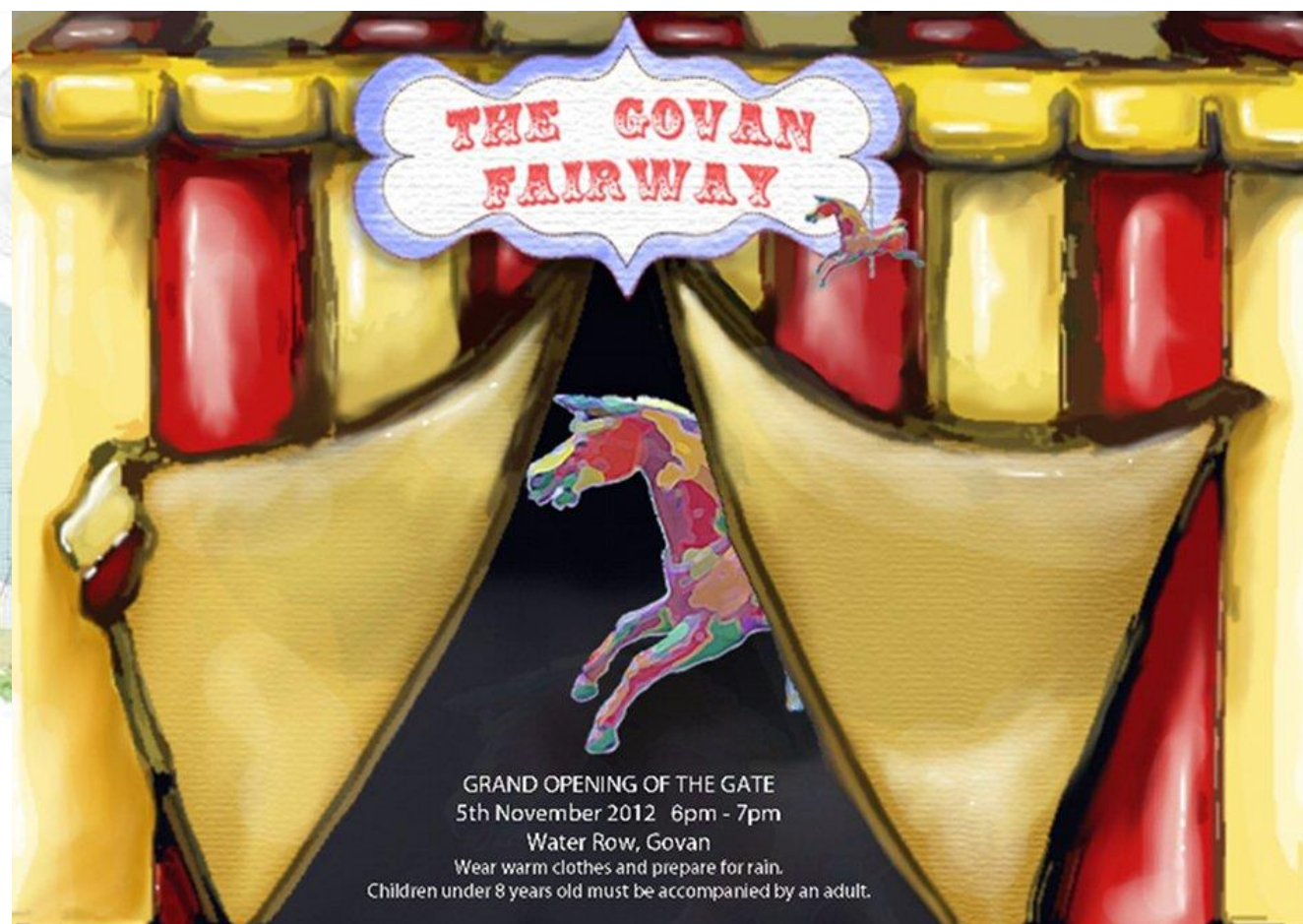
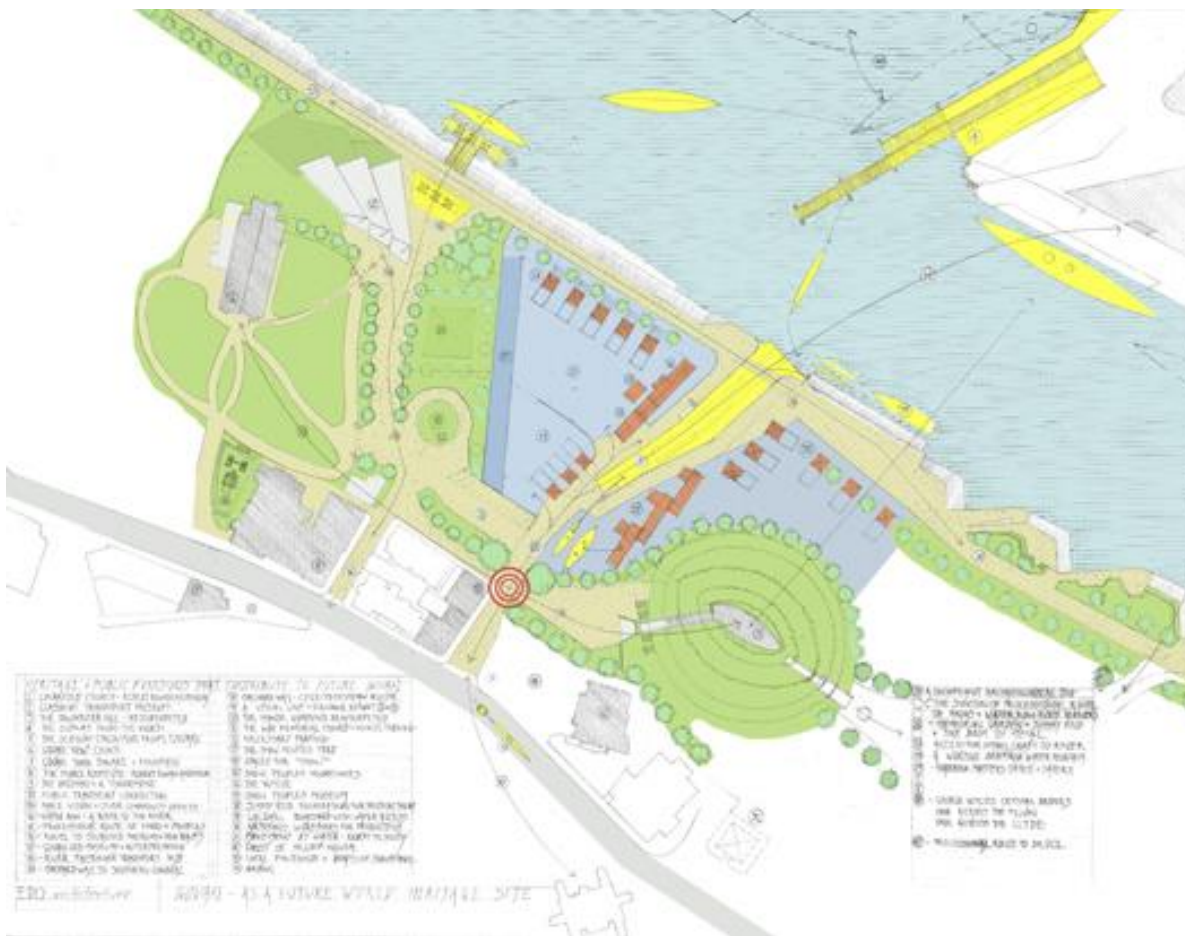

<http://http://edoarchitecture.com/>



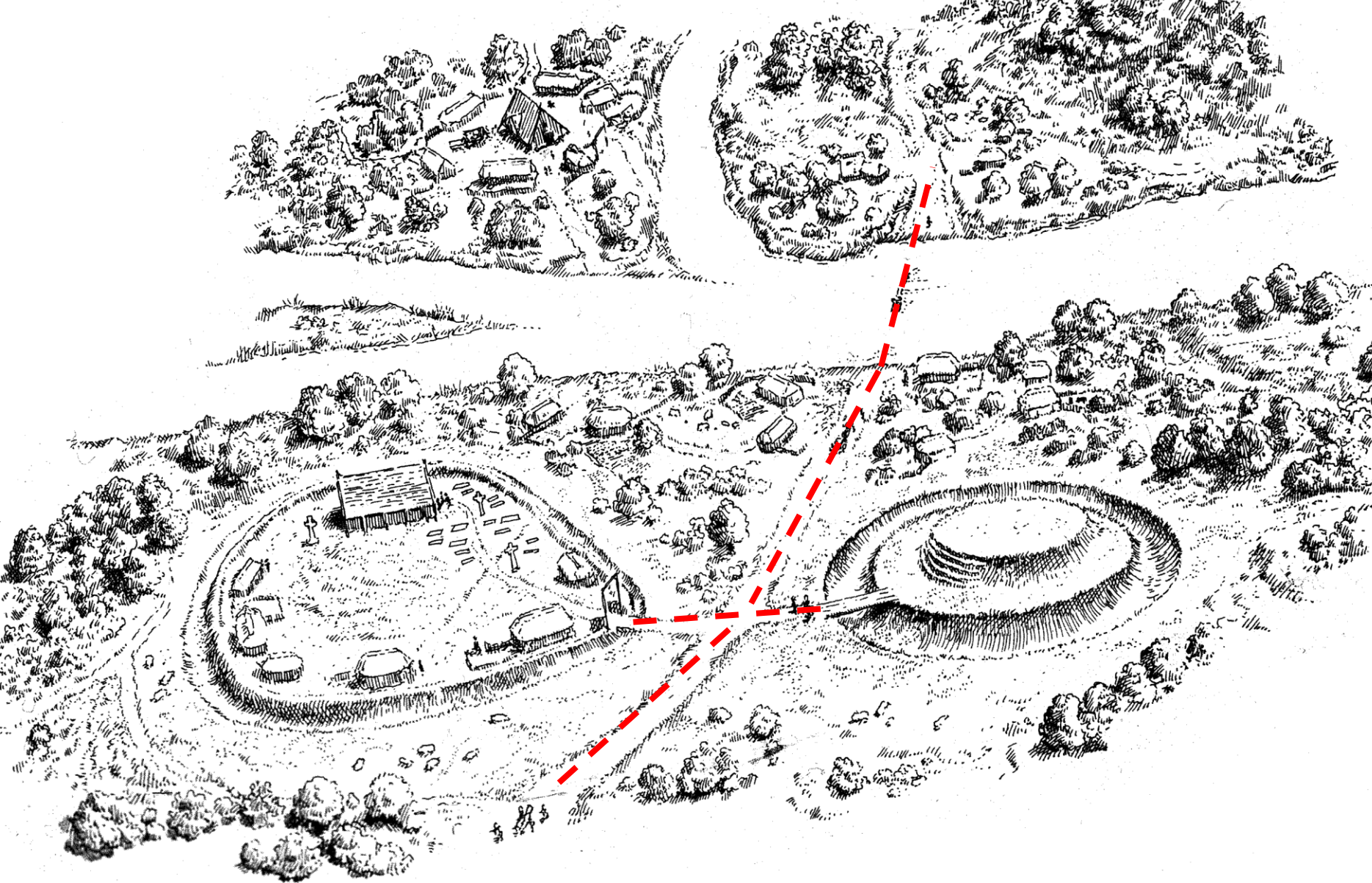

The upshot

Problem-orientated characterisation





The upshot

Public & collaborative characterisation



**IMAGINE WHAT  
COULD BE HERE**

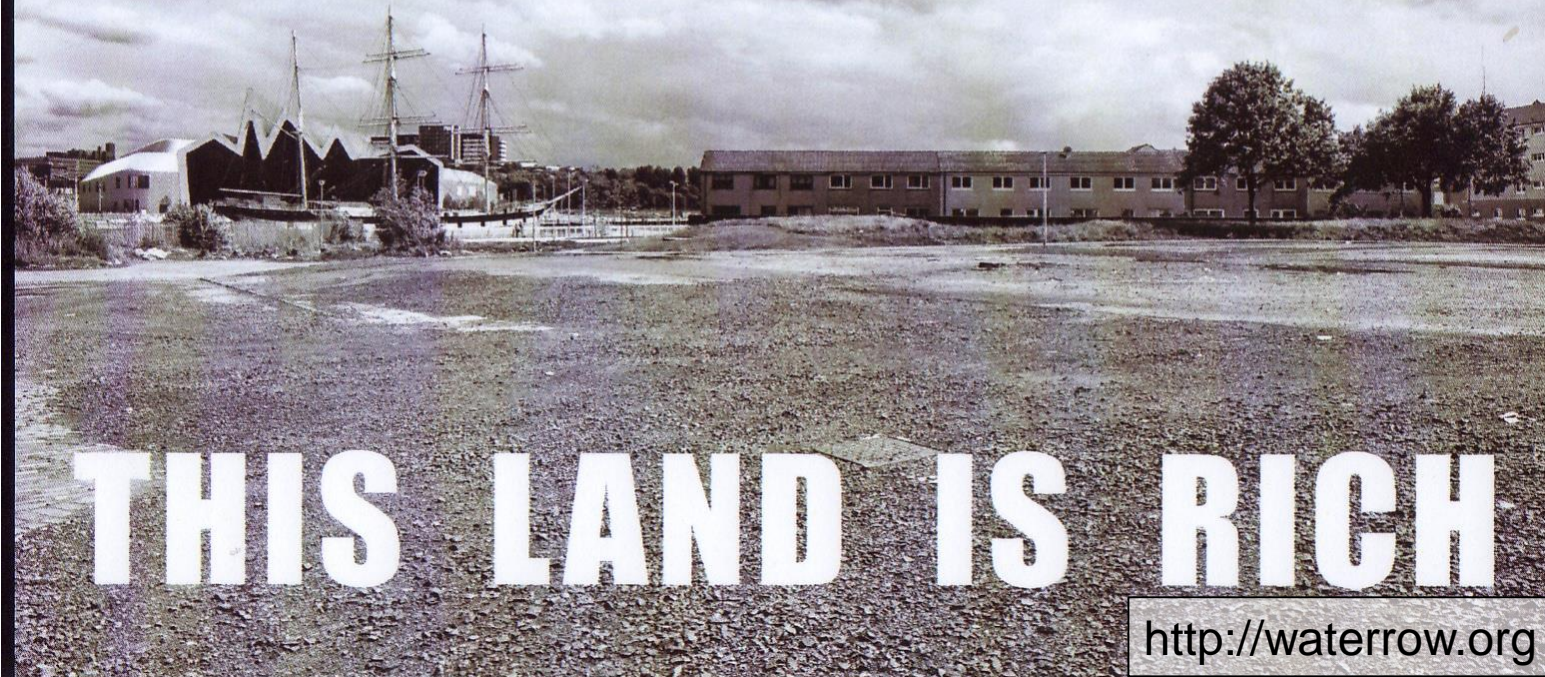

**THIS LAND IS RICH**

<http://waterrow.org>

The upshot

Emergent characterisation



Landscape: ‘a polity constituted by common *thing*  
meetings treating substantive *things that matter*’

Olwig, K 2013

‘great places . . . . bring life . . . . by getting people to  
build it themselves . . . . The arduous common task  
creates community – which is common life’

Rowe, C 2012

The upshot

Problem-orientated, public & collaborative, emergent  
characterisation